

# NU 240 ECML

SKF Explorer

## Dimensions

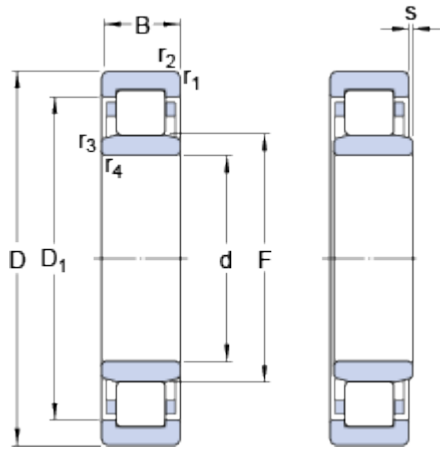

d		200	mm
D		360	mm
B		58	mm
D <sub>1</sub>	≈	311.5	mm
F		243	mm
r <sub>1,2</sub>	min.	4	mm
r <sub>3,4</sub>	min.	4	mm
s		2.6	mm

## Abutment dimensions

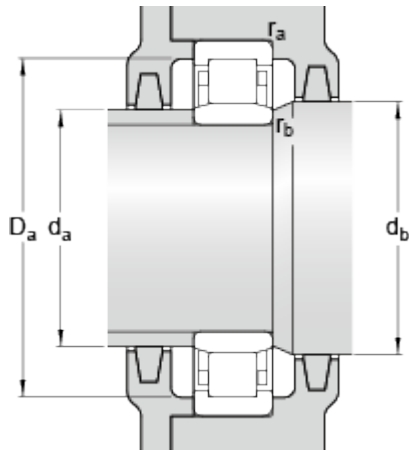

d <sub>a</sub>	min.	217	mm
d <sub>a</sub>	max.	238	mm
d <sub>b</sub>	min.	247	mm
D <sub>a</sub>	max.	341.6	mm
r <sub>a</sub>	max.	3	mm
r <sub>b</sub>	max.	3	mm

## Calculation data

Basic dynamic load rating	C	880	kN
Basic static load rating	C <sub>0</sub>	1060	kN
Fatigue load limit	P <sub>u</sub>	106	kN
Reference speed		1900	r/min
Limiting speed		3200	r/min
Calculation factor	k <sub>r</sub>	0.23	

## Mass

Mass bearing		26.52	kg
--------------	--	-------	----

## Appropriate products

Angle ring		HJ 240 EC	
------------	--	-----------	--

